

# PS60A33K

## 12Vac/DC Constant Current LED Driver

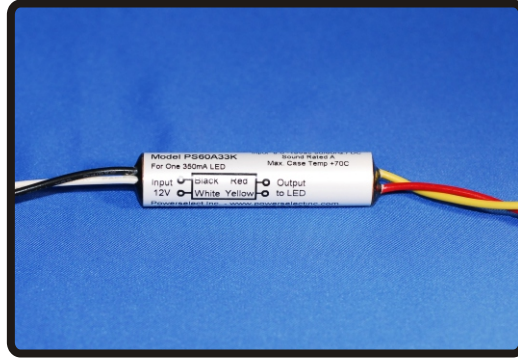

### INPUT SPECIFICATIONS

- Voltage 8-15 Vac/DC
- Current 0.09A@ 12V
- Frequency 50/60Hz / DC
- Power 1W

### OUTPUT SPECIFICATIONS

- 3.3V 330mA LED (constant)
- Short Circuit Protected
- Open Circuit Protected
- Output distance limited to 2 feet

### MECHANICAL / ENVIRONMENTAL

- Enclosure Overall Dimensions
- Unit Weight
- Minimum Operating Temperature
- Maximum Operating Temperature
- Sound Rating
- Encapsulated

0.475" Dia. x 2.0" Length  
1 oz.  
Min. Enclosure Temp  $-30^{\circ}\text{C}$   
Max. Enclosure Temp  $70^{\circ}\text{C}$   
Rated 'A'  
Polyurethane

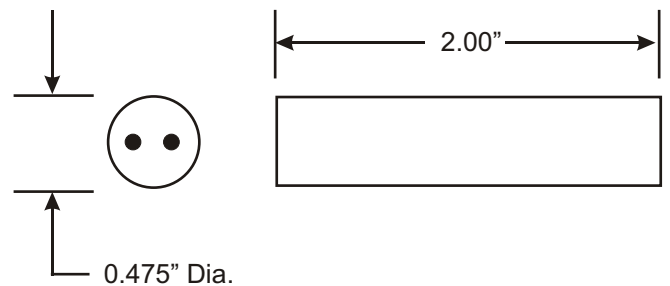
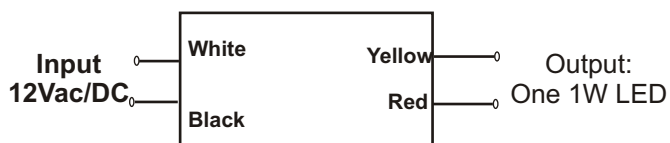

*PSI reserves the right to modify any specifications without notice..*